

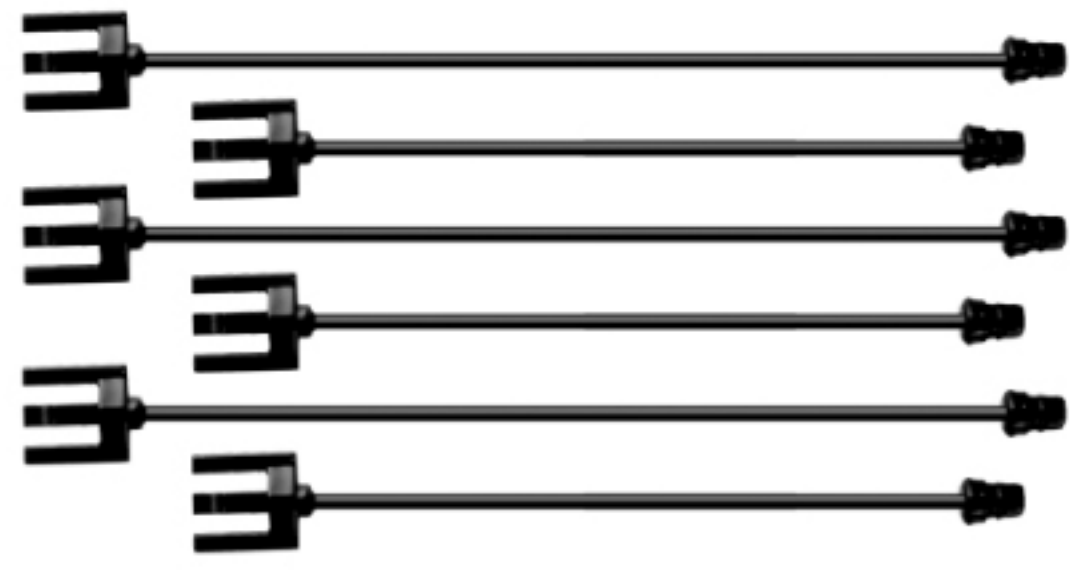

SPIN MAGIC™

★ NOTE: Please review instructions to ensure best results. Glow Markers have a characteristic scent which is safe and nontoxic.

3 Long Flexi-Clips (12")



3 Short Flexi-Clips (6")

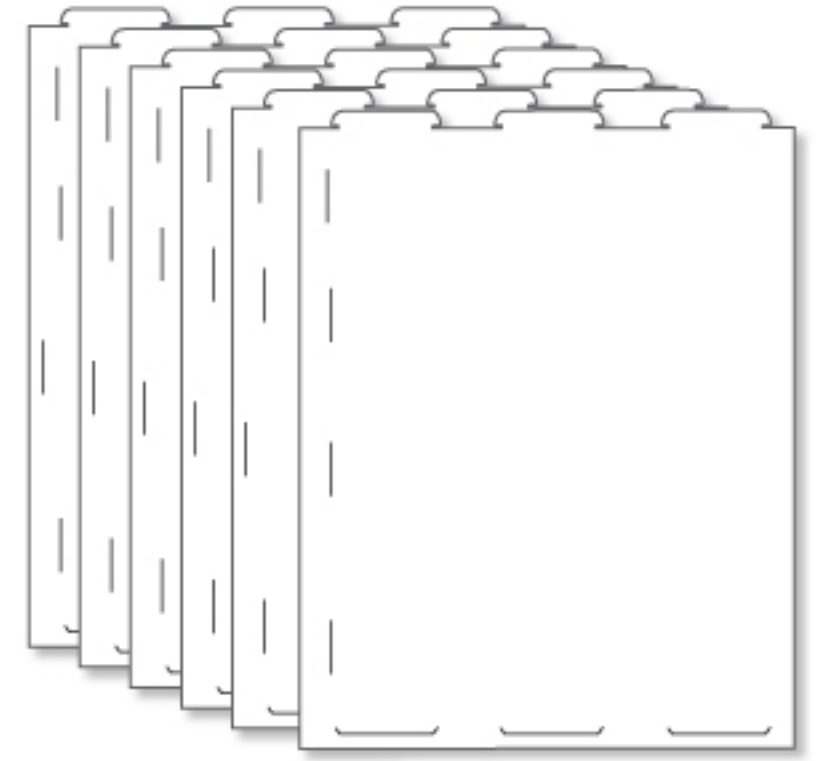

6 Glow Explosion Sheets

Inner Spin Disc
Outer Spin Disc



Spin Magic Base Unit



4 Glow Explosion Markers



Blotter Card



Glow Explosion Activator

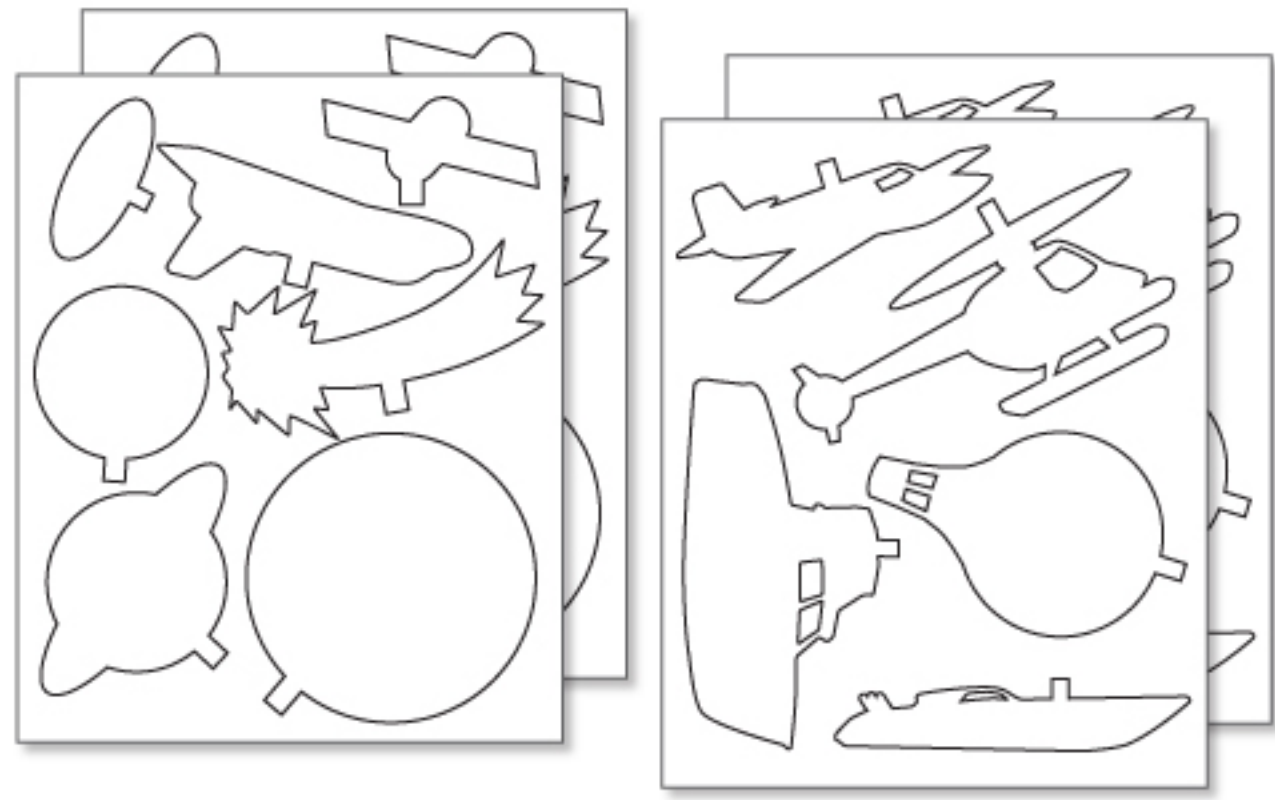

4 Glow Explosion Sheets with Pop & Clip Figures



5 Pop-Out Shadow Scenes

Get Started

- ★ Cover work surface with layers of scrap paper or sheets of aluminum foil. Glow Explosion Marker ink bleeds through paper and contains colorants that stain.
- 1 Remove Glow Markers from foil packet. Discard desiccant and put packet on work surface.
- 2 Press each Glow Marker tip straight down on foil packet for 2-3 seconds and release. Tips should appear moist and colored with ink.



Tips & Tricks

- Use Glow Explosion Markers only on Glow Explosion Paper. Color on dull side only. Shiny side should face down.
- Marker colors appear light on Glow Paper. Recoloring will not improve glow effect.
- Glow effect develops after applying Activator Marker and lasts up to 4 hours.
- The darker the room, the better the glow!
- If tip dries out while coloring, gently squeeze barrel to push ink into tip.
- Squeezing too hard may cause ink to drip out & puddle on paper. Blot quickly with paper towel.

Glowing Mobile

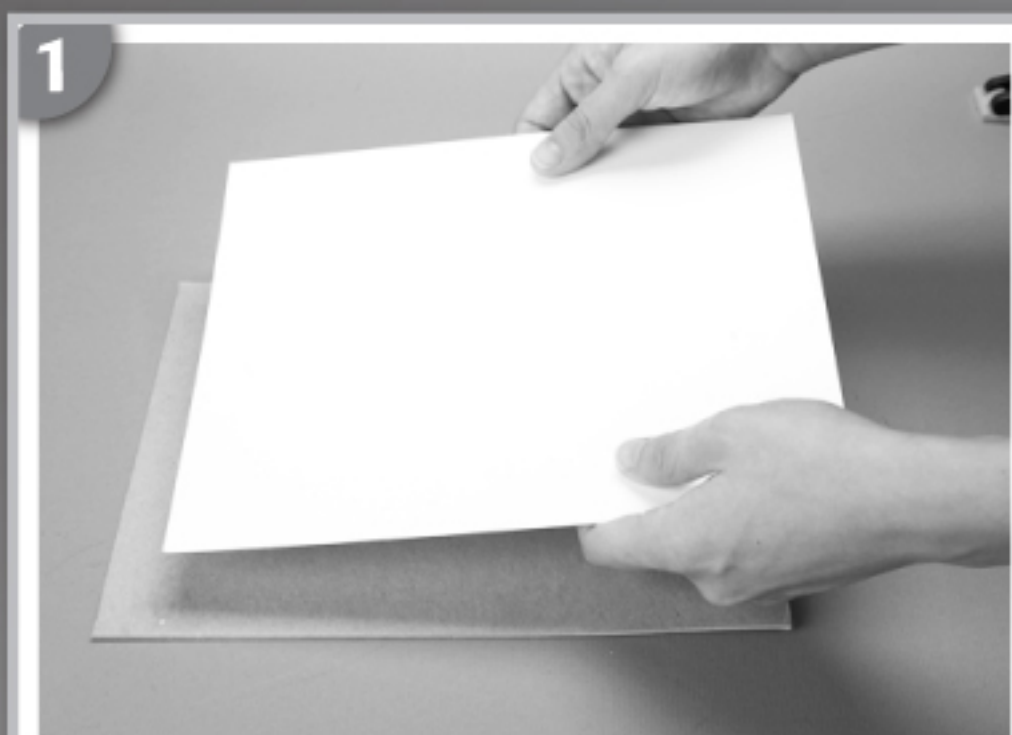

1 Place blotter mat on protected work surface. Place a Pop-Out Glow Sheet on blotter card with watermark (shiny) side down.

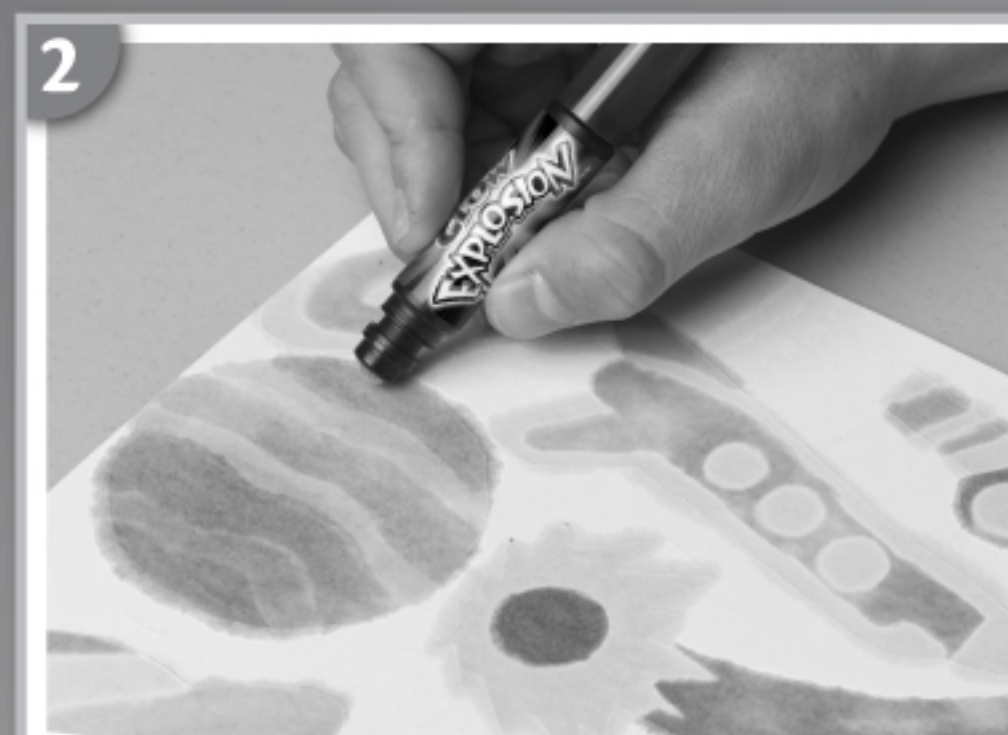

2 Color each figure with 1 or more markers. Try stripes or patterns but avoid blending colors. Recap markers after use.



3 Uncap Activator Marker. Use broad side of the tip with side-to-side or back & forth strokes to cover each colored figure.



4 Pop out figures along perforations and slide each one into the clip end of the Flexi-Clip.



5 Snap each long Flexi-Clip into a socket on Inner Spin Disc. Snap each short Flexi-Clip into a socket on Outer Spin Disc.



6 Flip the switch on the Base to set your mobile in motion. Then turn the lights out and enjoy the glow show!

- ★ For best results, ensure that the long Flexi-Clips are placed on the Inner Spin Disc and the short Flexi-Clips are placed on the outer Spin Disc.
- ★ Flexi-Clips may be bent, curved or curled in any direction.
- ★ To prevent staining, do not allow any mobile figures to touch any household surfaces, curtains or upholstery.

Glowing Scenes



1 Choose a black Shadow Sheet. Pop out all perforated areas and 4 accessory pieces with tabs along the top.



2 Roll ends of Shadow Sheet around to meet. Insert tab into slot to form a cylinder.



3 Color an entire Glowing Scene with 1 or more markers. Try multi-color stripe, zigzag or rainbow patterns. Avoid blending colors. Recap markers after use.



4 Uncap Activator Marker. Use broad strokes to cover the entire sheet. Recap Activator when finished.



5 Roll ends of Glowing Scene around to meet. Insert tabs into slots to form a cylinder.



6 Slide bottom of Glowing Scene cylinder into slots at ends of Inner Spin Disc.



7 Slide Shadow Sheet cylinder over Glowing Scene and secure bottom end in slots on Outer Spin Disc.

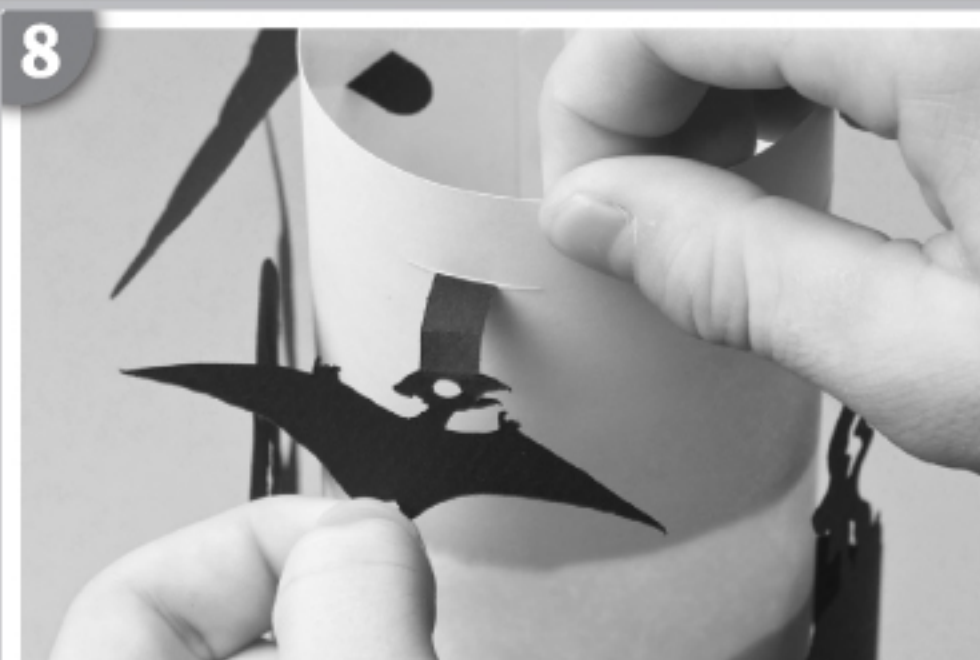

8 Bend tabs back on accessory pieces and insert through slots at top of Glowing Scene. NOTE: Mix & match accessory pieces from all Shadow Sheets for fun & wild effects.



9 Flip the switch on the Base to set your scene in motion. Then turn the lights out and enjoy the glow show!

BATTERY SPECIFICATION & CAUTIONS

CAUTION: BATTERIES MUST BE INSTALLED BY AN ADULT ONLY.

2 AA batteries 3 V (DC) • Do not use rechargeable batteries. • Non-rechargeable batteries are not to be recharged. • Different types of batteries or new and old batteries are not to be mixed. • Batteries must be inserted using correct polarity. • Remove and discard exhausted batteries properly as soon as possible. • Remove all batteries from compartment if toy will not be used for a long period (several months). • The supply terminals are not to be short-circuited.

WASHING & CARE INFORMATION

STAIN ADVISEMENT: Glow Explosion Markers contain colorants that stain and bleed through paper. Keep markers and completed artwork away from fabric, wallpaper, painted walls, finished and unfinished wood, vinyl, carpeting, countertops and other household surfaces. Protect clothing during use. Cover all work surfaces to avoid staining. To display: Lay a clean sheet of Glow Explosion Paper or enclosed blotter card under finished artwork before displaying on any household surface. Do not hang finished art directly on porous surfaces like kitchen appliances, countertops, walls and cabinets.

CODE#: 74-4148-0-101
Contents and colors may vary.
Keep instructions for future reference.

SAFETY INFORMATION

Conforms to ASTM D 4236.
ALL CRAYOLA ART
MATERIALS ARE NONTOXIC.
Glow Markers are certified AP.



WARNING! Not suitable for children under 36 months due to small parts which may cause a choking hazard if swallowed.

QUALITY GUARANTEE

We guarantee the quality of all Crayola products. If this product does not perform properly, please contact us.

In the U.S.A. and Canada, call **1-800-CRAYOLA** (800-272-9652), weekdays 9 AM-4 PM ET.

In Europe, call **+33 (0) 1 41 06 54 54**, weekdays 9 AM-5 PM local time.

In the UK, call **01702 208170**, weekdays 9 AM-5 PM local time.

In Mexico, call **01800 71 78 222**, weekdays 9 AM-5 PM local time.

In Australia, call Crayola AU at **1-800-657-353**, weekdays 9 AM-4 PM AEST.

crayola.com



A Hallmark Company

©2010 Crayola, Easton, PA 18044-0431. Distributed in Australia by Crayola (Australia) Pty. Ltd. Imported by Binney & Smith (Europe) Ltd., Bedford Heights, Manton Lane, Bedford, Beds, MK41 7PH, England. Patent Pending.

NO BATTERIES INCLUDED



The Wheeler Bin symbol indicates that the product and the batteries must not be disposed of with other household waste as they may contain elements which can have a harmful effect on the environment and human health. Please use designated collection points or recycling facilities when disposing of the item and the batteries. To help locate your nearest facility see: www.recyclenow.com